

Zubehör zu Simalube
Accessoires Simalube

Bogen / Coude "45°"

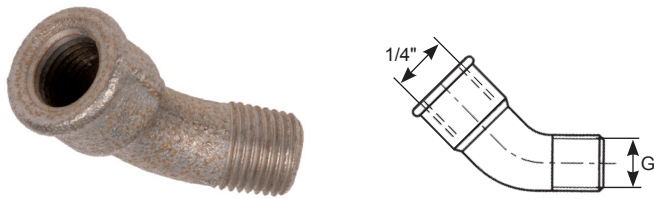

G	Prod-No	Art-No
R 1/4"	290.1001	650713

Bogen / Coude "90°"

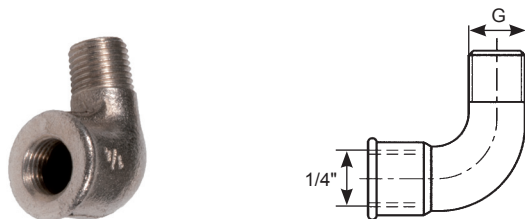

G	Prod-No	Art-No
R 1/4"	290.1002	650714

Bogen schwenkbar / Coude pivotant "90°"

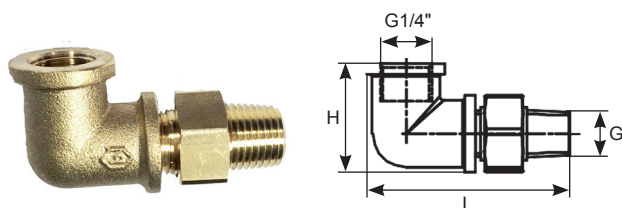

G	L x H mm	Prod-No	Art-No
R1/4"	51,00 x 27,75	290.1004	650807 n)

90°-Anschluss mit Gewinde und 2 Muttern / Raccord 90° avec filetage et 2 écrous

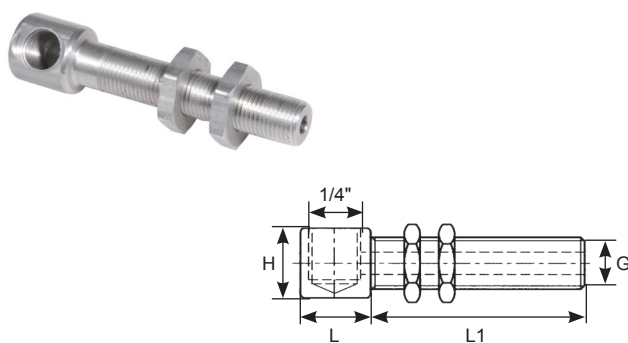

G	L1 x L x H mm	Prod-No	Art-No
R1/4"	20 x 70 x 20	290.1005	650715

Anschlussnippel / Raccord

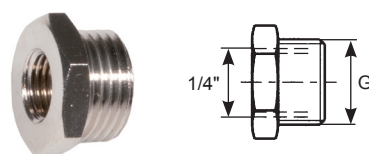

G	Prod-No	Art-No
R 3/8"	290.1010	650716
R 1/2"	290.1011	650717

Reduziernippel / Raccord de réduction

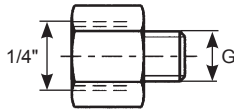
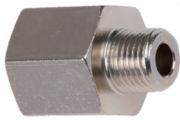

G	Prod-No	Art-No
R 1/8"	290.1020	650718
R 1/4"	290.1021	650719
M6	290.1022	650720
M8	290.1023	650721
M8 x 1	290.1024	650722
M10	290.1025	650723
M10 x 1	290.1026	650724
M12	290.1027	650725
M12 x 1,5	290.1028	650726

Verlängerung / Rallonge

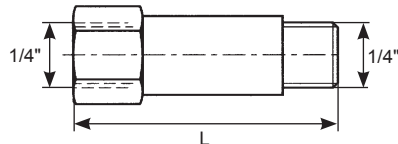
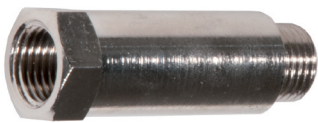

L mm	Prod-No	Art-No
35	290.1040	650727
50	290.1041	650728

Schottverschraubung / Raccord passe cloison

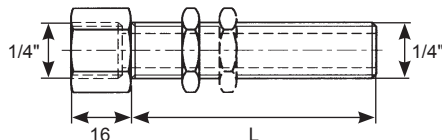
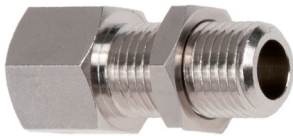

L mm	Prod-No	Art-No
25	290.1045	650729
60	290.1046	650730

25 mm; inkl. 1 Mutter / *incl. une écrou*
60 mm; inkl. 2 Muttern / *incl. deux écrous*

Y-Anschluss-Stück / Raccord Y

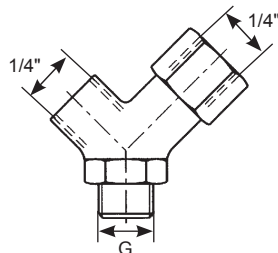

G	Prod-No	Art-No
R 1/4"	290.1050	650731

enthält Reduziernippel 1021
contient raccord de réduction 1021

Steckverschraubung / Raccord à emboîter

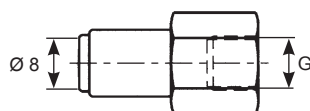
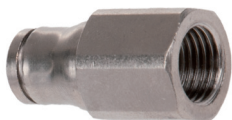

G	Prod-No	Art-No
R 1/4"	290.1060	650732

für Schlauch: Ø 8 mm
pour tuyau: Ø 8 mm

Zubehör zu Simalube
Accessoires Simalube

Steckverschraubung / Raccord à emboîter

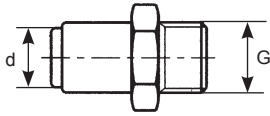

G	d mm	Prod-No	Art-No
R 1/4"	8	290.1071	650733
R 1/8"	8	290.1070	650734
R 3/8"	8	290.1072	650735

für Schlauch: Ø 8 mm
pour tuyau: Ø 8 mm

Halteschelle für Simalube / Bride de fixation pour simalube

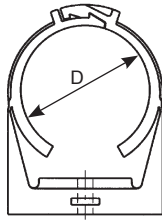

D mm	Prod-No	Art-No
50	290.2010	650736

Material: Kunststoff
matériel: plastique

Adapter für Perma-Schelle / Adaptateur de fixation Perma

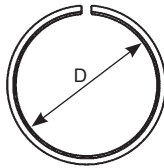

D mm	Prod-No	Art-No
50	290.2012	650737

Material: Kunststoff
matériel: plastique

Halteschelle für Pinsel / Bride de fixation pour pinceau

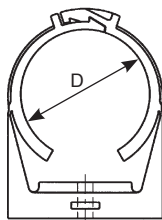

D mm	Prod-No	Art-No
28	290.2013	650738

Material: Kunststoff
matériel: plastique

Distanzhalter zu Halteschelle für Pinsel / Entretoise pour bride de fixation pour pinceau

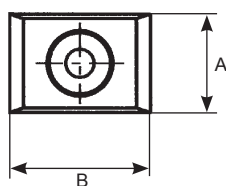
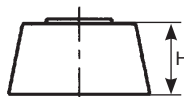
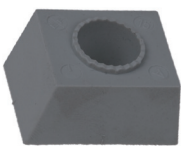

H mm	A mm	B mm	Prod-No	Art-No
15	20	30	290.2014	650739

Montagesupport / Support de montage

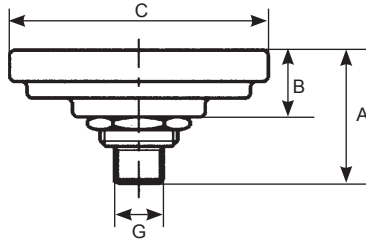

G	A mm	B mm	C Ø mm	Prod-No	Art-No
R 1/4"	36	18	70	290.2080	650740

Schutzhaube zu Montagesupport 2080 / Capot de protection pour support de montage 2080

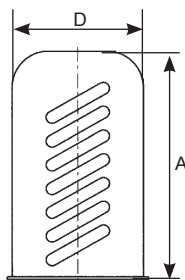

D mm	A mm	Prod-No	Art-No
50	103	290.2081	650741

Material: Stahl
matériel: acier

Rückschlagventile / Clapets anti-retour

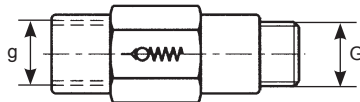
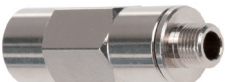

g mm	G mm	Prod-No	Art-No
1/4"	R 1/8"	290.2020	650742
1/4"	R 1/4"	290.2021	650743

Pinsel / Pinceau

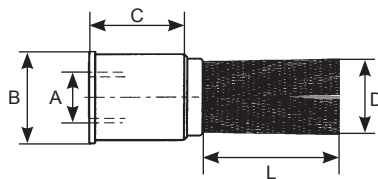

L x D mm	A mm	B mm	C mm	Prod-No	Art-No
25 x 45	1/4"	28	30	290.2034	650744

Kunststoff-Borsten
poils en matière synthétique

Pinsel / Pinceau

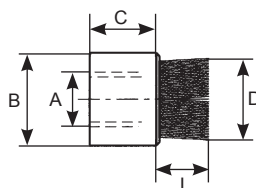

L x D mm	A mm	B mm	C mm	Prod-No	Art-No
25 x 15	1/4"	28	17	290.2041	650745

Rosshaar-Borsten
poils en crin de cheval

Bürsten / Brosses

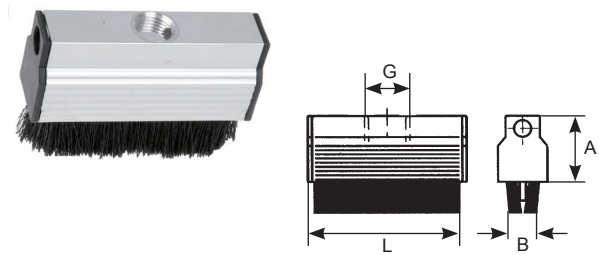

G	L	A	B	Prod-No	Art-No
	mm	mm	mm		
1/4"	25	31,5	23	290.2038	650746
1/4"	40	31,5	23	290.2035	650747
1/4"	70	31,5	23	290.2036	650748
1/4"	100	31,5	23	290.2037	650749

Rosshaar-Borsten
poils en crin de cheval

Bürsten, Anschluss seitlich / Brosses, à connection latérale

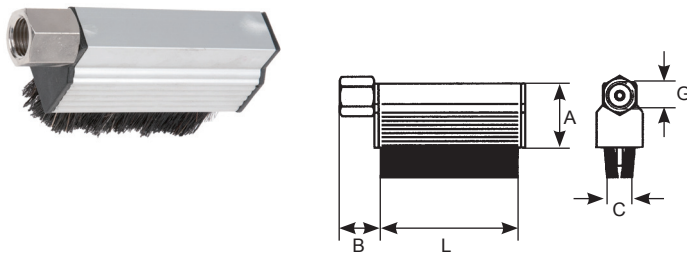

G	L	A x B	C	Prod-No	Art-No
	mm	mm	mm		
1/4"	40	31,5 x 17,5	23	290.2035-S	650750
1/4"	70	31,5 x 17,5	23	290.2036-S	650751
1/4"	100	31,5 x 17,5	23	290.2037-S	650752

Rosshaar-Borsten
poils en crin de cheval

Aufzugsbürsten / Brosses pour ascenseurs

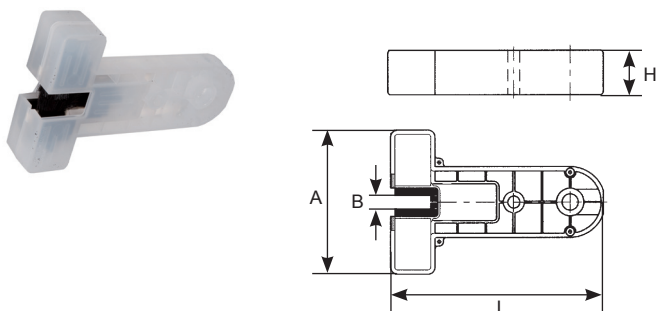

H	L	A	B	Prod-No	Art-No
mm	mm	mm	mm		
31,5	151	102	5 - 16	290.2039	650753
31,0	113	84	5 - 16	290.2042	650754

Support, universell verstellbar / Support réglage universel

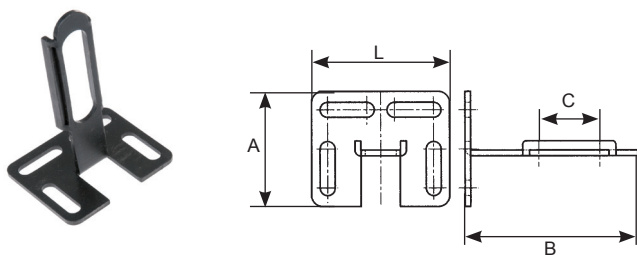

A	L	B	C	Prod-No	Art-No
mm	mm	mm	mm		
50	60	84	35	290.2800	650755

Nachfüllnippel / Graisseur de recharge

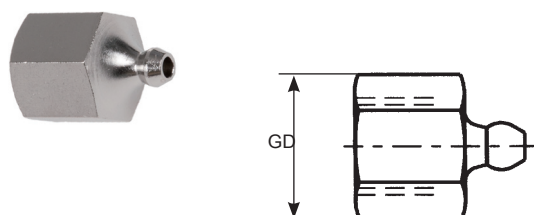

G	Prod-No	Art-No
R 1/4"	290.3012	650756

zum Nachfüllen des Simalube
pour la recharge du simalube

Zubehör zu Simalube Accessoires Simalube

Anschlussnippel / Raccords

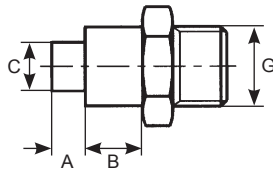

G	A mm	B mm	C Ø mm	Prod-No	Art-No
R 1/4"	6	10	7,8	290.3013	650757
R 3/8"	6	10	7,8	290.3014	650758

zum Befüllen des Simalube mit Fettpressenfüller
pour appareil de remplissage de pompe à graisse

4-fach Adapter / Adaptateurs quadruples

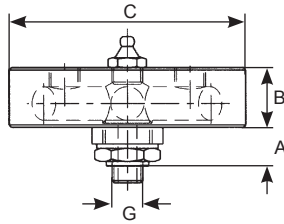

G	A mm	B mm	C Ø mm	Prod-No	Art-No
R 1/2"	16	25	100	290.4100	650759
R 1/4"	16	25	100	290.4101	650760

Antriebsköpfe / Têtes de commande

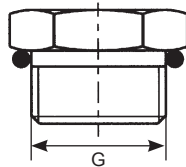

für Kartusche pour cartouche ml	Gewinde filetage G	Prod-No	Art-No
60	M18 x 1,5	220.5006	650761
125	M18 x 1,5	220.5008	650762

Verschlussstopfen / Bouchon de fermeture

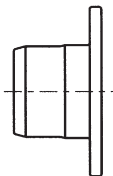

Prod-No	Art-No
290.5050	650763

Material: Kunststoff
matériel: plastique

Rückschlagventilstopfen / Bouchon anti-retour

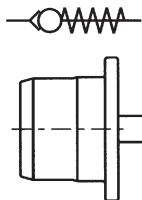

Prod-No	Art-No
290.5060	650764

Material: Kunststoff
matériel: plastique

Dichtungsring / Joint d'étanchéité

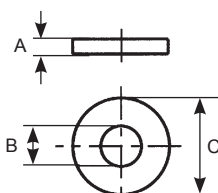

A mm	B mm	C mm	Prod-No	Art-No
3	5	11,6	290.5080	650765